LICENSING SUB-COMMITTEE C

TUESDAY 14 NOVEMBER, 2006 at 19:00 HRS
CIVIC CENTRE, HIGH ROAD, WOOD GREEN, LONDON N22 8LE.

MEMBERS: Councillors Patel (Chair) substituting Dobbie, Demirci substituting Beacham, and Reid.

AGENDA

- 1. APOLOGIES FOR ABSENCE**
- 2. URGENT BUSINESS: (PAGES 1 - 34)**

The Chair will consider the admission of any late items of urgent business. (Late items will be considered under the agenda item where they appear. New items will be dealt with at Item 6 below).

- 3. DECLARATIONS OF INTEREST:**

A member with a personal interest in a matter who attends a meeting of the Authority at which the matter is considered must disclose to that meeting the existence and nature of that interest at the commencement of that consideration, or when the interest becomes apparent.

A member with a personal interest in a matter also has a prejudicial interest in that matter if the interest is one which a member of the public with knowledge of the relevant facts would reasonably regard as so significant that it is likely to prejudice the member's judgement of the public interest.

- 4. SUMMARY OF PROCEDURE: (PAGES 35 - 38)**

The Chair will explain the procedure that the Committee will follow for each of the hearings considered under the Licensing Act 2003. A copy of the procedure is attached.

5. WETHERSPOONS, UNIT 5 SPOUTERS CORNER, HIGH ROAD N22 (NOEL PARK WARD): (PAGES 39 - 80)

To consider an application for a variation of a premises licence to allow for regulated entertainment.

6. ITEMS OF URGENT BUSINESS:

To consider any new items admitted under item 2 above.

YUNIEA SEMAMBO
Head of Member Services
River Park House
225 High Road
Wood Green
LONDON N22 8HQ

NICOLAS MATTIS
Principal Committee Co-ordinator
Tel: 020 8489 2916
Fax: 020 8489 2660
nicolas.mattis@haringey.gov.uk
www.haringey.gov.uk

6 NOVEMBER 2006
9 NOVEMBER 2006

Licensing Act 2003 Sub-Committee 7th NOVEMBER 2006

Report title: Application FOR A PREMISES LICENCE AT GLADESMORE COMMUNITY SCHOOL, CROWLAND ROAD, LONDON N15 6EB

Report of: The Lead Officer - Licensing

Ward(s) affected

1. Purpose

To consider an application by GLADESMORE COMMUNITY SCHOOL to allow for regulated entertainment.

2. Recommendations

- 2.1**
- (a) Grant the application as asked
 - (b) Modify the conditions of the licence, by altering or omitting or adding to them
 - (c) Reject the whole or part of the application

The Committee is asked to note that it may not modify the conditions or reject the whole or part of the application unless it is necessary to promote the licensing objectives.

Report authorised by: Robin Payne.....

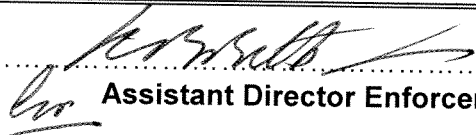
 Assistant Director Enforcement Services

Contact Officer: Ms Daliah Barrett

Telephone: 020 8489 5103

3. Executive summary

For consideration by Sub Committee under Licensing Act 2003 for a Premises Licence.

4. Access to information:

Local Government (Access to Information) Act 1985
 Background Papers

The following Background Papers are used in the preparation of this Report:
File: Gladesmore

The Background Papers are located at Enforcement Service, Civic Centre, High Road Wood Green N22

5. REPORT

Background

5.1 Application by **GLADESMORE COMMUNITY SCHOOL** for a Premises License in respect of **GLADESMORE COMMUNITY SCHOOL, CROWLAND ROAD, LONDON N15 6EB** for regulated entertainment under the Licensing Act 2003.

The application seeks permission for the school hall and gym and the Adjoining external courtyard area.

5.2 Details of application - APP 1

Opening Hours for Public

Monday to Saturday 09.00.a.m. – 23.00.pm.

Regulated Entertainment

Monday to Saturday 09.00.a.m. – 23.00.pm

The Operating Schedule.

5.3 Crime and Disorder

SEE SECTION P OF THE APPLICATION FORM

5.4 Public Safety

SEE SECTION P OF THE APPLICATION FORM

5.5 Public Nuisance

SEE SECTION P OF THE APPLICATION FORM

5.6 Child Protection

SEE SECTION P OF THE APPLICATION FORM

6. RELEVANT REPRESENTATIONS (CONSULTATION)

Responsible Authorities:

6.1 Comments of Metropolitan Police

The Police have no comments to make regarding this application.

6.2 Comments of Enforcement Services:

Noise Team

Have notified of recommendations in relation to noise. App 2.

Food Team

Have no objections to this application

Health and Safety

Have no objections to this application

Trading Standards

Have no objections to this application

6.3 Fire Officer

The Fire Officer has made no representation in relation to this application.

6.4 Planning Officer

Planning have made no representation on this matter.

6.5. Comments of Child Protection Agency or Nominee

Have no objections to this application.

7.0 Interested Parties

2 letters of representation has been received against this application. **App 3**

8.0 Financial Comments

The fee which would be applicable for this application is **£100.00**

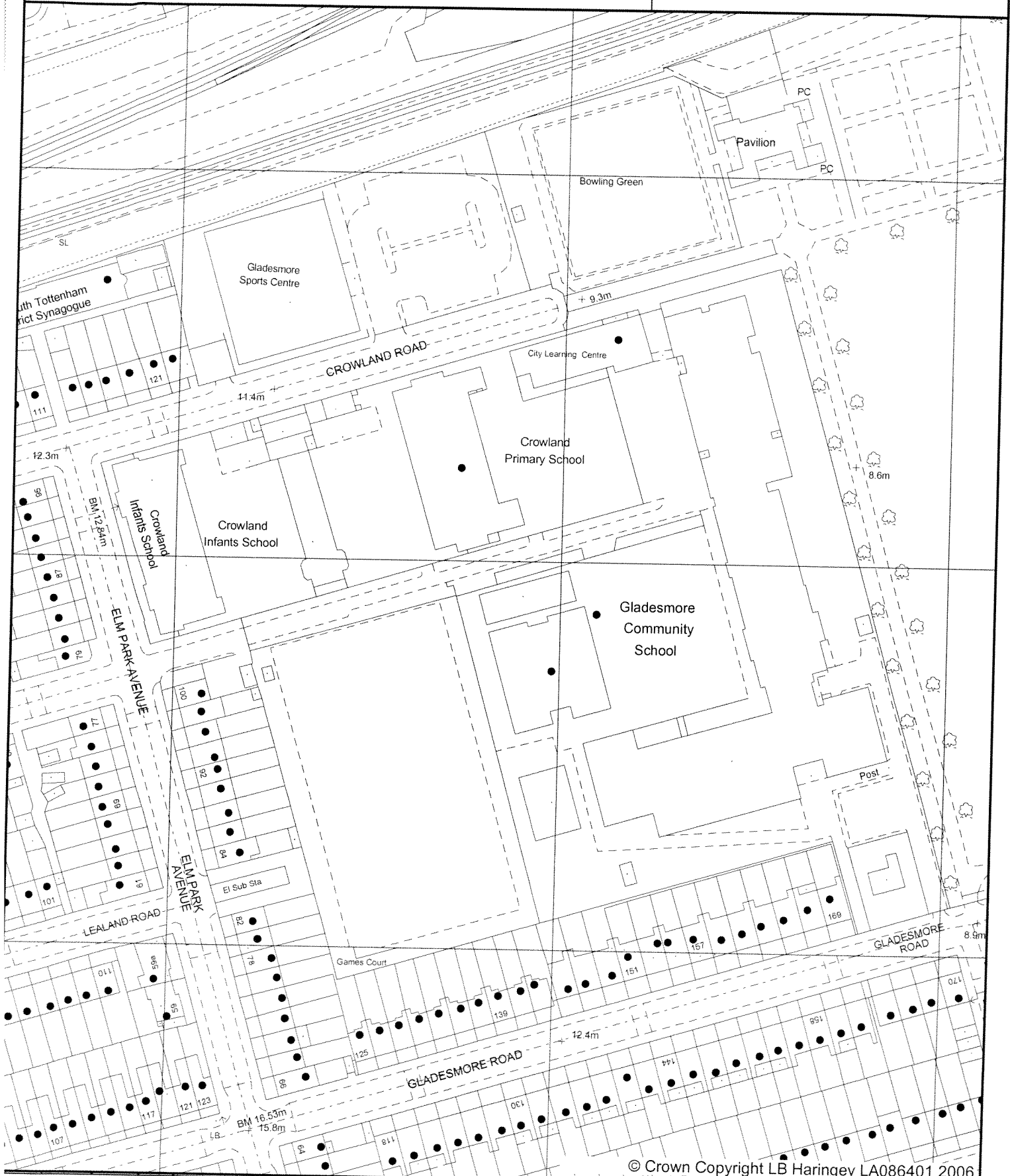

© Crown Copyright LB Haringey LA086401 2006

Enforcement Service
 Civic Centre
 High Road
 Wood Green
 London
 N22 8LE



Environmental Control



Scale: 1:1294

Appendix 1

APPLICATION FORM

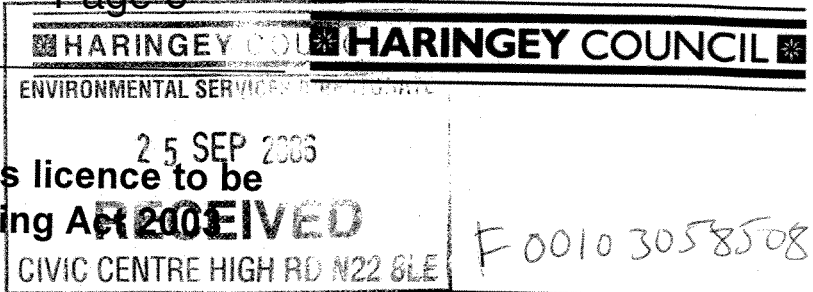

Application for a premises licence to be granted under the Licensing Act 2003

(1)

Reference number:

PLEASE READ THE FOLLOWING INSTRUCTIONS FIRST

Before completing this form please read the guidance notes at the end of the form. If you are completing this form by hand please write legibly in block capitals. In all cases ensure that your answers are inside the boxes and written in black ink. Use additional sheets if necessary. You may wish to keep a copy of the completed form for your records

(2) I/We GLADESMORE COMMUNITY SCHOOL

apply for a premises licence under section 17 the Licensing Act 2003 for the premises described in Part 1 below (the premises) and I/we are making this application to you as the relevant licensing authority in accordance with section 12 of the Licensing Act 2003

Part 1 - Premises details

Postal address of premises or, if none, Ordnance Survey map reference or description <u>CROWLAND ROAD</u>	
Post town <u>LONDON</u>	Postcode <u>N15 6EB</u>

Telephone number at premises(if any) 0208 800 0884

Non-domestic rateable value of premises £ /

Part 2 - Applicant details

Please state whether you are applying for a premises licence as

- Please tick yes
- a) an individual or individuals* please complete section (A)
 - b) a person other than an individual*
 - i. as a limited company please complete section (B)
 - ii. as a partnership please complete section (B)
 - iii. as an unincorporated association; or please complete section (B)
 - iv. other (for example a statutory corporation) please complete section (B)

(1) Insert name and address of relevant licensing authority and its reference number (optional)
(2) Insert name(s) of applicant

- c) a recognised club please complete section (B)
- d) a charity please complete section (B)
- e) the proprietor of an educational establishment please complete section (B)
- f) a health service body please complete section (B)
- g) a person who is registered under Part 2 of the Care Standards Act 2000 (c14) in respect of an independent hospital please complete section (B)
- h) the chief officer of police of a police force in England and Wales please complete section (B)

* If you are applying as a person described in (a) or (b) please confirm:

- I am carrying on or proposing to carry on a business which involves the use of the premises for licensable activities; or Please tick ✓ yes
- I am making the application pursuant to
 - a statutory function; or
 - a function discharged by virtue of Her Majesty's prerogative

(A) INDIVIDUAL APPLICANTS (fill in as applicable)

Mr Mrs Miss Ms Other title
 (for example, Rev)

Surname First names

I am 18 years old or over Please tick ✓ yes Date of birth

Day	Month	Year
<input type="text"/>	<input type="text"/>	<input type="text"/>

Current postal address if different from premises address

Post town Postcode

Daytime contact telephone number

E-mail address (optional)

SECOND INDIVIDUAL APPLICANT (if applicable)

Mr Mrs Miss Ms Other title
 (for example, Rev)

Surname First names

I am 18 years old or over Please tick yes
 Date of birth Day Month Year

Current postal address if different from premises address

Post town Postcode

Daytime contact telephone number

E-mail address (optional)

(B) OTHER APPLICANTS

Please provide name and registered address of applicant in full. Where appropriate please give any registered number. In the case of a partnership or other joint venture (other than a body corporate), please give the name and address of each party concerned.

Name	GLADESMORE COMMUNITY SCHOOL
Address	CROWLAND RD TOTTENHAM LONDON
Registered number (where applicable)	
Description of applicant (for example partnership, company, unincorporated association etc.)	COMMUNITY SCHOOL
Telephone number (if any)	0208 800 0884
E-mail address (optional)	

When do you want the premises licences to start?

Day	Month	Year
28	10	2006

If you wish the licence to be valid only for a limited period, when do you want it to end?

Day	Month	Year

Please give a general description of the premises (please read guidance note 1)

GLADESMORE SCHOOL HAS A HALL AND A GYM WHICH WILL BE USED FOR EVENTS, AS WELL AS A COURTYARD AREA ADJOINING THE BUILDING. THE SCHOOL HALL HAS A STAGE AT ONE END AND AN ADJOINING CAFE AREA. THESE PARTS OF THE SCHOOL ARE IN A NON RESIDENTIAL AREA.

If 5,000 or more people are expected to attend the premises at any one time, please state the number expected to attend

--

What licensable activities do you intend to carry on from the premises?
(Please see sections 1 and 14 of the Licensing Act 2003 and Schedule 1 and 2 to the Licensing Act 2003)

Provision of regulated entertainment

Please tick yes

- a) plays (if ticking yes, fill in box A)
- b) films (if ticking yes, fill in box B)
- c) indoor sporting events (if ticking yes, fill in box C)
- d) boxing or wrestling entertainment (if ticking yes, fill in box D)
- e) live music (if ticking yes, fill in box E)
- f) recorded music (if ticking yes, fill in box F)
- g) performances of dance (if ticking yes, fill in box G)
- h) anything of a similar description to that falling within (e), (f) or (g) (if ticking yes, fill in box H)

Provision of entertainment facilities for:

- i) making music (if ticking yes, fill in box I)
- j) dancing (if ticking yes, fill in box J)
- k) entertainment of a similar description to that falling within (i) or (j) (if ticking yes, fill in box K)

Provision of late night refreshment (if ticking yes, fill in box L)

Supply of alcohol (if ticking yes, fill in box M)

In all cases complete boxes N, O and P

A

Plays			Will the performance of a play take place indoors or outdoors or both - please tick <input checked="" type="checkbox"/> (please read guidance note 2)
Day	Start	Finish	
Mon	09.00	23.00	Indoors <input type="checkbox"/> Outdoors <input type="checkbox"/> Both <input checked="" type="checkbox"/>
Tue	09.00	23.00	
Wed	09.00	23.00	Please give further details here (please read guidance note 3) THIS APPLICATION IS SEEKING TO COVER A RANGE OF ACTIVITIES WHICH MAY OCCUR IN THE SCHOOL AND COMMUNITIES ANNUAL PROGRAMME. GLADESMORE HOPE TO HOST EVENTS RANGING FROM CULTURAL MUSIC AND PLAYS TO CHILDRENS SHOWCASES AND INVITED PROFESSIONALS
Thur	09.00	23.00	
Fri	09.00	23.00	State any seasonal variations for performing plays (please read guidance note 4)
Sat	09.00	23.00	
Sun	09.00	23.00	
			Non-standard timings. Where you intend to use the premises for the performance of plays at different times from those listed in the column on the left, please list (please read guidance note 5)

B

Films			Will the exhibition of films take place indoors or outdoors or both - please tick <input checked="" type="checkbox"/> (please read guidance note 2)
Day	Start	Finish	
Mon	09.00	23.00	Indoors <input type="checkbox"/> Outdoors <input type="checkbox"/> Both <input checked="" type="checkbox"/>
Tue	09.00	23.00	
Wed	09.00	23.00	Please give further details here (please read guidance note 3) GLADESMORE HOPE TO HOST FILM EVENINGS FOR LOCAL COMMUNITY GROUPS AND FOR PUPILS AND THEIR PARENTS
Thur	09.00	23.00	
Fri	09.00	23.00	State any seasonal variations for the exhibition of films (please read guidance note 4)
Sat	09.00	23.00	
Sun	09.00	23.00	
			Non-standard timings. Where you intend to use the premises for the exhibition of films at different times from those listed in the column on the left, please list (please read guidance note 5)

C

Indoor sporting events			Please give further details here (please read guidance note 3) GLADESMORE WILL UTILISE THE HALL AND GYM TO SHOWCASE THE TALENTS OF PUPILS AND THE LOCAL COMMUNITY. AT TIME PROFESSIONALS MAY ALSO BE INVITED TO PERFORM AT THE SCHOOL
Day	Start	Finish	
Mon	09.00	23.00	State any seasonal variations for indoor sporting events (please read guidance note 4)
Tue	09.00	23.00	
Wed	09.00	23.00	Non-standard timings. Where you intend to use the premises for indoor sporting events at different times from those listed in the column on the left, please list (please read guidance note 5)
Thur	09.00	23.00	
Fri	09.00	23.00	
Sat	09.00	23.00	
Sun	09.00	23.00	

D

Boxing or wrestling entertainments			Will the boxing or wrestling entertainment take place indoors or outdoors or both - please tick <input checked="" type="checkbox"/> (please read guidance note 2) Indoors <input type="checkbox"/> Outdoors <input type="checkbox"/> Both <input type="checkbox"/>
Day	Start	Finish	
Mon			Please give further details here (please read guidance note 3)
Tue			
Wed			State any seasonal variations for boxing or wrestling entertainment (please read guidance note 4)
Thur			
Fri			Non-standard timings. Where you intend to use the premises for boxing or wrestling entertainment at different times from those listed in the column on the left, please list (please read guidance note 5)
Sat			
Sun			

E

Live music			Will the performance of live music take place indoors or outdoors or both - please tick <input checked="" type="checkbox"/> (please read guidance note 2)
Standard days and timings (please read guidance note 6)			
Day	Start	Finish	Indoors <input type="checkbox"/> Outdoors <input type="checkbox"/> Both <input checked="" type="checkbox"/>
Mon	09.00	23.00	Please give further details here (please read guidance note 3) GLADESMORE WILL SHOWCASE THE TALENTS OF PUPILS AND COMMUNITY AS WELL AS HOSTING EVENTS SUCH AS BLACK HISTORY MONTH AND INVITING PROFESSIONAL ARTISTS TO PERFORM AT THE SCHOOL
Tue	09.00	23.00	
Wed	09.00	23.00	State any seasonal variations for the performance of live music (please read guidance note 4)
Thur	09.00	23.00	
Fri	09.00	23.00	
Sat	09.00	23.00	Non-standard timings. Where you intend to use the premises for the performance of live music at different times from those listed in the column on the left, please list (please read guidance note 5)
Sun	09.00	23.00	

F

Recorded music			Will the playing of recorded music take place indoors or outdoors or both - please tick <input checked="" type="checkbox"/> (please read guidance note 2)
Standard days and timings (please read guidance note 6)			
Day	Start	Finish	Indoors <input type="checkbox"/> Outdoors <input type="checkbox"/> Both <input checked="" type="checkbox"/>
Mon	09.00	23.00	Please give further details here (please read guidance note 3) GLADESMORE WILL HOST MUSIC EVENTS FOR THE LOCAL COMMUNITY AND FOR PUPILS AND THEIR FAMILIES
Tue	09.00	23.00	
Wed	09.00	23.00	State any seasonal variations for the playing of recorded music (please read guidance note 4)
Thur	09.00	23.00	
Fri	09.00	23.00	
Sat	09.00	23.00	Non-standard timings. Where you intend to use the premises for the playing of recorded music entertainment at different times from those listed in the column on the left, please list (please read guidance note 5)
Sun	09.00	23.00	

G

Performances of dance Standard days and timings (please read guidance note 6)			Will the performance of dance take place indoors or outdoors or both - please tick <input checked="" type="checkbox"/> (please read guidance note 2)
Day	Start	Finish	
Mon	09.00	23.00	Indoors <input type="checkbox"/> Outdoors <input type="checkbox"/> Both <input checked="" type="checkbox"/>
Tue	09.00	23.00	Please give further details here (please read guidance note 3) GLADESMORE WILL SHOWCASE THE WORK OF PUPILS AND THE LOCAL COMMUNITY AS WELL AS WORKING WITH INVITED PROFESSIONALS AT THE SCHOOL
Wed	09.00	23.00	State any seasonal variations for the performance of dance (please read guidance note 4)
Thur	09.00	23.00	
Fri	09.00	23.00	Non-standard timings. Where you intend to use the premises for the performance of dance entertainment at different times from those listed in the column on the left, please list (please read guidance note 5)
Sat	09.00	23.00	
Sun	09.00	23.00	

H

Anything of a similar description to that falling within (e), (f) or (g) Standard days and timings (please read guidance note 6)			Please give a description of the type of entertainment you will be providing
Day	Start	Finish	
Mon			Will this entertainment take place indoors or outdoors or both - please tick <input checked="" type="checkbox"/> (please read guidance note 2)
Tue			Indoors <input type="checkbox"/> Outdoors <input type="checkbox"/> Both <input type="checkbox"/>
Wed			Please give further details here (please read guidance note 3)
Thur			State any seasonal variations for entertainment of a similar description to that falling within (e), (f) or (g) (please read guidance note 4)
Fri			Non-standard timings. Where you intend to use the premises for the entertainment of similar description to that falling within (e), (f) or (g) at different times from those listed in the column on the left, please list (please read guidance note 5)
Sat			
Sun			

Provision of facilities for making music			Please give a description of the facilities for making music you will be providing THIS WILL VARY FROM DJING TO DRUMMING AND TRADITIONAL MUSIC
Standard days and timings (please read guidance note 6)			Will the facilities for making music be indoors or outdoors or both - please tick <input checked="" type="checkbox"/> (please read guidance note 2)
Day	Start	Finish	Indoors <input type="checkbox"/> Outdoors <input type="checkbox"/> Both <input checked="" type="checkbox"/>
Mon	09 00	23 00	Please give further details here (please read guidance note 3) GADESMORE WOULD LIKE TO FACILITATE MUSIC WORKSHOPS FOR PUPILS AND THE LOCAL COMMUNITY
Tue	09 00	23 00	
Wed	09 00	23 00	State any seasonal variations for the provision of facilities for making music (please read guidance note 4)
Thur	09 00	23 00	
Fri	09 00	23 00	Non-standard timings. Where you intend to use the premises for provision of facilities for making music at different times from those listed in the column on the left, please list (please read guidance note 5)
Sat	09 00	23 00	
Sun	09 00	23 00	

J

Provision of facilities for dancing			Please give a description of the facilities for dancing you will be providing THE HALL AND THE GYM WILL BE USED FOR DANCE CLASSES, ASWELL AS TO DANCE AT PERFORMANCES
Standard days and timings (please read guidance note 6)			Will the facilities for dancing be indoors or outdoors or both - please tick <input checked="" type="checkbox"/> (please read guidance note 2)
Day	Start	Finish	Indoors <input type="checkbox"/> Outdoors <input type="checkbox"/> Both <input type="checkbox"/>
Mon	09 00	23 00	Please give further details here (please read guidance note 3) PEOPLE WILL BE ABLE TO PARTICIPATE IN DANCE EVENTS AND CLASSES
Tue	09 00	23 00	
Wed	09 00	23 00	State any seasonal variations for providing dancing facilities (please read guidance note 4)
Thur	09 00	23 00	
Fri	09 00	23 00	Non-standard timings. Where you intend to use the premises for the provision of facilities for dancing entertainment at different times from those listed in the column of the left, please list (please read guidance note 5)
Sat	09 00	23 00	
Sun	09 00	23 00	

K

Provision of facilities for entertainment of a similar description to that falling within I or J			Please give a description of the type of entertainment facility you will be providing
			Will the entertainment facility be indoors or outdoors or both - please tick <input checked="" type="checkbox"/> (please read guidance note 2)
Standard days and timings (please read guidance note 6)			Indoors <input type="checkbox"/> Outdoors <input type="checkbox"/> Both <input type="checkbox"/>
Day	Start	Finish	Please give further details here (please read guidance note 3)
Mon			
			State any seasonal variations for the provision of facilities for entertainment of a similar description to that falling within I or J (please read guidance note 4)
Tue			
			Non-standard timings. Where you intend to use the premises for the provision of facilities for entertainment of a similar description to that falling within I or J at different times from those listed in the column on the left, please list (please read guidance note 5)
Wed			
Thur			
Fri			
Sat			
Sun			

L

Late night refreshment			Will the provision of late night refreshment take place indoors or outdoors or both - please tick <input checked="" type="checkbox"/> (please read guidance note 2) Indoors <input type="checkbox"/> Outdoors <input type="checkbox"/> Both <input type="checkbox"/>
Standard days and timings (please read guidance note 6)			
Day	Start	Finish	Please give further details here (please read guidance note 3)
Mon			
Tue			
Wed			
			State any seasonal variations for the provision of late night refreshment (please read guidance note 4)
Thur			
Fri			Non-standard timings. Where you intend to use the premises for the provision of late night refreshment at different times from those listed in the column on the left, please list (please read guidance note 5)
Sat			
Sun			

M

Supply of alcohol			Will the sale of alcohol be for consumption - please tick box <input checked="" type="checkbox"/> (please read guidance note 7) On the premises <input type="checkbox"/> Off the premises <input type="checkbox"/> Both <input type="checkbox"/>
Standard days and timings (please read guidance note 6)			
Day	Start	Finish	State any seasonal variations for the supply of alcohol (please read guidance note 4)
Mon			
Tue			
Wed			
			Non-standard timings. Where you intend to use the premises for the supply of alcohol at different times from those listed in the column on the left, please list (please read guidance note 5)
Thur			
Fri			
Sat			
Sun			

State the name and details of the individual whom you wish to specify on the licence as premises supervisor

Name

Address

Postcode

Personal Licence number (if known)

Issuing licensing authority (if known)

N

Please highlight any adult entertainment or services, activities, other entertainment or matters ancillary to the use of the premises that may give rise to concern in respect of children (please read guidance note 8)

O

Hours premises are open to the public

Standard days and timings
(please read guidance note 6)

Day	Start	Finish
Mon	09:00	23:00
Tue	09:00	23:00
Wed	09:00	23:00
Thur	09:00	23:00
Fri	09:00	23:00
Sat	09:00	23:00
Sun	09:00	23:00

State any seasonal variations (please read guidance note 4)

Non-standard timings. Where you intend to use the premises to be open to the public at different times from those listed in the column on the left, please list (please read guidance note 5)

P Describe the steps you intend to take to promote the four licensing objectives:

a) General - all four licensing objectives (b, c, d, e) (please read guidance note 9)

GLADESMORE SCHOOL WILL ENSURE THAT EVENTS MEET THE LICENSE OBJECTIVES. COMMUNITY GROUPS HIRING THE HALL WILL BE REQUIRED TO SUBMIT A PLAN SHOWING HOW THESE OBJECTIVES WILL BE MET.

EVENTS WILL BE REQUIRED TO DO A RISK ASSESSMENT TO DETERMINE STEWARD / SECURITY ARRANGEMENTS
ALL EVENTS WILL HAVE TO ADHERE TO SAFETY REGULATIONS

b) The prevention of crime and disorder

GLADESMORE SCHOOL WILL LIAISE WITH THE POLICE ABOUT THE PROGRAMME OF EVENTS

STEWARDS AND SECURITY WILL BE INCORPORATED WHERE NECESSARY

EVENTS WILL BE VETTED TO PREVENT TROUBLESOME ELEMENTS AND PROGRAMMING WILL BE CAREFULLY CONSIDERED

c) Public safety

ALL EQUIPMENT WILL BE SIGNED OFF BEFORE USE.

BARRIERS WILL BE USED TO PREVENT PUBLIC ACCESS WHERE NEEDED

SECURITY IN PLACE TO ATTEND TO PROBLEMS WHEN NECESSARY

CONTRACTORS SELECTED ON GROUNDS OF SAFETY, EXPERIENCE AND QUALITY

EACH EVENT TO CHECK SUPPLIERS / CONTRACTORS SAFETY DOCS.

FIRE EXTINGUISHERS PLACED BY POWER / ELECTRICAL EQUIPMENT AND AROUND VENUE. EAR PLUGS AVAILABLE

d) The prevention of public nuisance

AUDIENCE ASKED TO LEAVE QUIETLY

PARKING AVAILABLE AT VENUE

SOUND SYSTEMS PLACED TO AVOID NUISANCE

LARGE VEHICLE MOVEMENT RESTRICTED TO BETWEEN 9AM AND 9.30 PM.

e) The protection of children from harm

THE VENUE IS A SCHOOL AND PLACES CHILDRENS WELFARE HIGH ON ITS AGENDA. THE SCHOOL HAS MANY CRB CHECKED STAFF WHO CAN BE ON CALL FOR EVENTS.

ACTIVITIES AT THE SCHOOL WILL HAVE A FAMILY / COMMUNITY FOCUS

CHECKLIST:

Please tick ✓

- I have made or enclosed payment of the fee
- I have enclosed the plan of the premises
- I have sent copies of this application and the plan to responsible authorities and others where applicable
- I have enclosed the consent form completed by the individual I wish to be premises supervisor, if applicable
- I understand that I must now advertise my application
- I understand that if I do not comply with the above requirements my application will be rejected

IT IS AN OFFENCE, LIABLE ON CONVICTION TO A FINE UP TO LEVEL 5 ON THE STANDARD SCALE, UNDER SECTION 158 OF THE LICENSING ACT 2003 TO MAKE A FALSE STATEMENT IN OR IN CONNECTION WITH THIS APPLICATION

Part 4 - Signatures (please read guidance note 10)

Signature of applicant or applicant's solicitor or other duly authorised agent. (Please read guidance note 11)
If signing on behalf of the applicant please state in what capacity.

Signature x  ROGER JF ANDRE

Date x 21st September 2006

Capacity x School Busbar

For joint applications signature of 2nd applicant, 2nd applicant's solicitor or other authorised agent.
(Please read guidance note 12)

If signing on behalf of the applicant please state in what capacity.

Signature _____

Date _____

Capacity _____

Contact name (where not previously given) and postal address for correspondence associated with this application (please read guidance note 13)	
MEL WILDS CONTINENTAL DRIFTS 14 HATHERLEY MEWS LONDON, E17 4QP	
Post town LONDON	Postcode E17 4QP
Telephone number (if any) 0208 509 3353	
If you would prefer us to correspond with you by e-mail your e-mail address (optional) mel@continentaldrifts.co.uk	

Notes for Guidance

1. Describe the premises. For example the type of premises, its general situation and layout and any other information which could be relevant to the licensing objectives. Where your application includes off-supplies of alcohol and you intend to provide a place for consumption of these off-supplies you must include a description of where the place will be and its proximity to the premises.
2. Where taking place in a building or other structure please tick as appropriate. Indoors may include a tent.
3. For example the type of activity to be authorised, if not already stated, and give relevant further details, for example (but not exclusively) whether or not music will be amplified or unamplified.
4. For example (but not exclusively), where the activity will occur on additional days during the summer months.
5. For example (but not exclusively), where you wish the activity to go on longer on a particular day e.g. Christmas Eve.
6. Please give timings in 24 hour clock (e.g. 16:00) and only give details for the days of the week when you intend the premises to be used for the activity.
7. If you wish people to be able to consume alcohol on the premises please tick 'on the premises', if you wish people to be able to purchase alcohol to consume away from the premises please tick 'off the premises'. If you wish people to be able to do both please tick 'both'.
8. Please give information about anything intended to occur at the premises or ancillary to the use of the premises which may give rise to concern in respect of children, regardless of whether you intend children to have access to the premises, for example (but not exclusively) nudity or semi-nudity, films for restricted age groups, the presence of gaming machines.
9. Please list here steps you will take to promote all four licensing objectives together.
10. The application form must be signed.
11. An applicant's agent (for example solicitor) may sign the form on their behalf provided that they have actual authority to do so.
12. Where there is more than one applicant, both applicants or their respective agents must sign the application form.
13. This is the address which we shall use to correspond with you about this application.

SITE PLAN

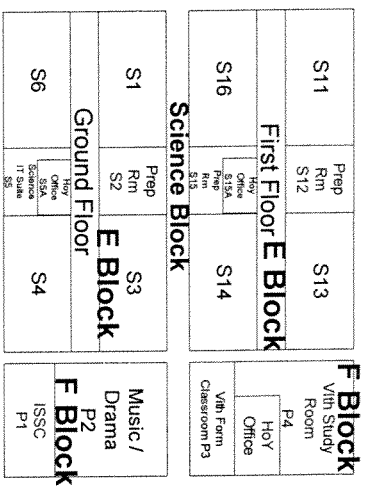
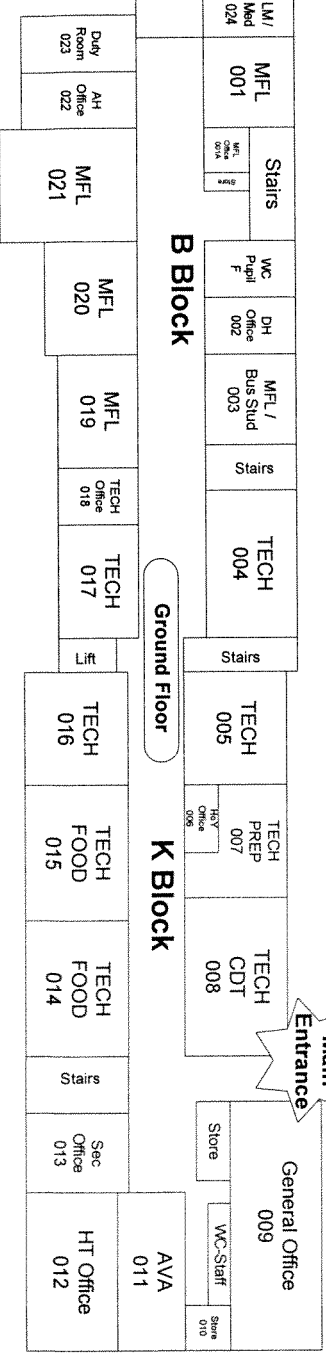
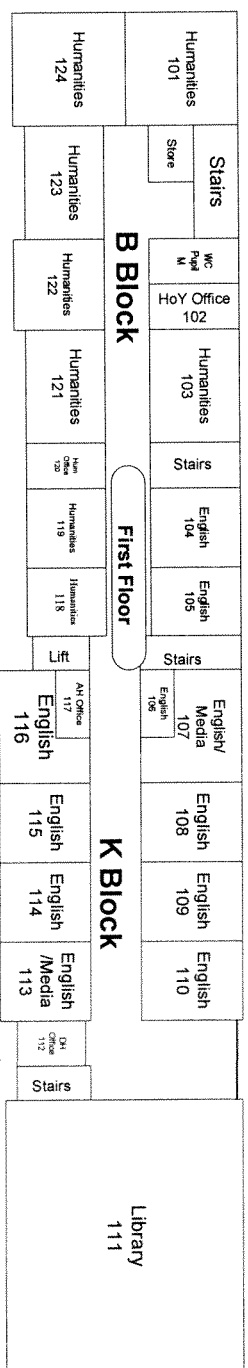
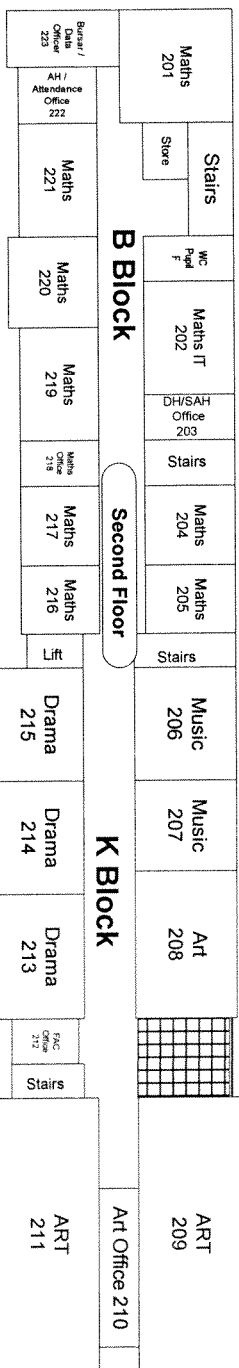
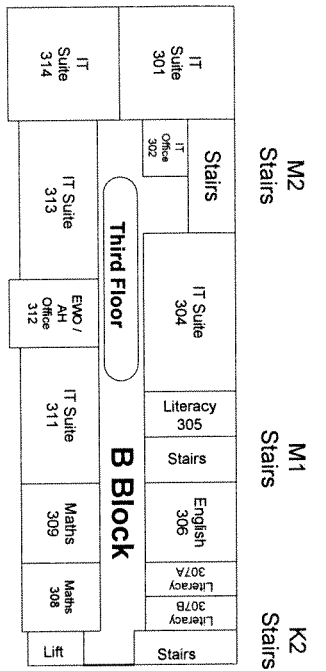
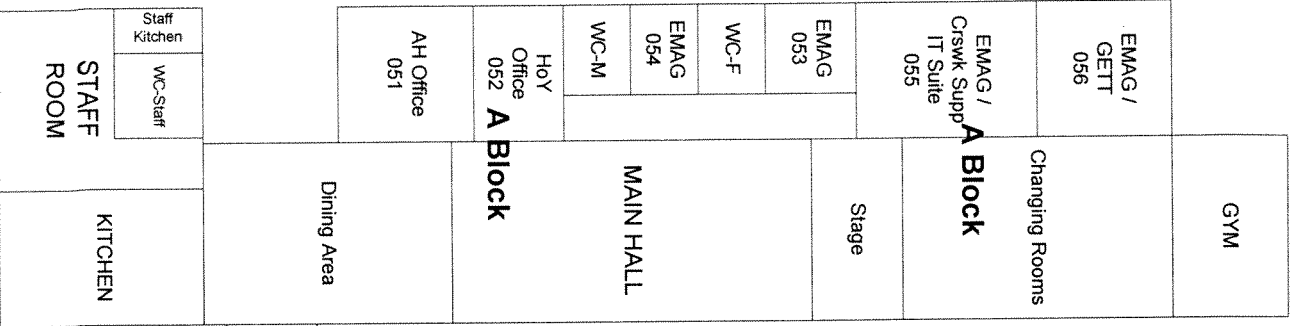
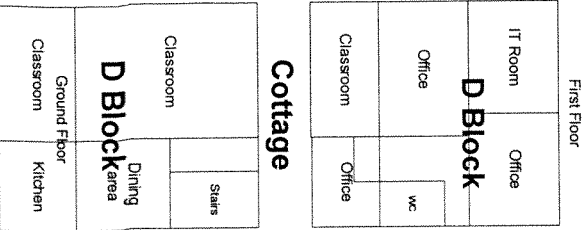
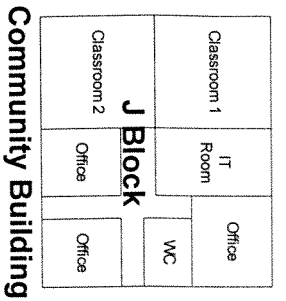
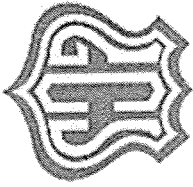

Appendix 2

RECOMMENDATIONS FROM NOISE TEAM

LICENSING CONSULTATION -INTERNAL MEMO

To: D Barrett, Licensing Officer

From: S Thompson, EHO Noise Team

Cc: D Pearce Noise Team Leader

Date: 5th October 2006

Premises: Gladesmore Community School, Crowland Road, N15 6EB

Type of application: Licensing Act 2003.

I would like to confirm that the above proposal has been discussed with regard to the prevention of public nuisance. On behalf of Enforcement Service Noise Team I would like to:

Make representations on the Application.

On the following grounds:

The information provided does not address the prevention of public nuisance from

- Airborne entertainment noise

Supporting Information

Gladesmore School is located in a mainly residential area with a few commercial premises in the vicinity.

The Noise Team have not taken any action regarding this address.

Informative

I would recommend the following conditions to the operating schedule:

Sound limits

The licensee shall ensure that no music played in the licensed is audible at or within the site boundary of any residential property.

Outside areas

No form of loudspeaker or sound amplification equipment is to be sited on or near the exterior premises or in or near any foyer, doorway, window, or opening to the premises.

Recommendation

The Noise Team have considered the application and nature of noise sensitive domestic premises.

We do not oppose the application but the licence, if granted, will require special conditions attached. See above

Appendix 3

REPRESENTATIONS FROM RESIDENTS

**Gladesmore Rd Residents Association
139 Gladesmore Rd
London N15 6TJ**

10 October 2006
The London Borough Of Haringey
Licensing Team
Civic Centre
High Road
London N22 8LE

Re: Gladesmore Community School Application for Premises License to Permit:

All listed activities from Monday to Sunday 9am - 11pm including:

- Plays
- Films
- Indoor sporting events
- Live music
- Dance performances
- Making music
- Dance

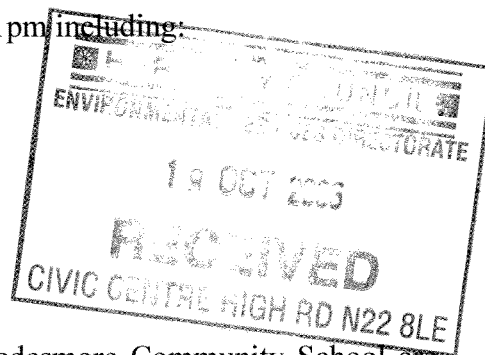

We, the residents of the streets bordering onto Gladesmore Community School are vigorously opposed to the above application. We are appalled at the underhanded and deceitful way this application has been made knowledge to us. It is an impertinence to tie a little laminated letter onto a small tree at the bottom of the road detailing these preposterous plans, instead of delivering a proper letter to each resident in the local and surrounding area. It is clear that the school has hoped that this would miss the attention of the residents and that these plans would go through unopposed.

This will not happen. There are many reasons that we will not support this application.

- Noise pollution. It is ludicrous to imagine that residents would support live music and noisy performances from 9am to 11pm, 6 days a week. Noise abuse is unacceptable and illegal.
- Litter. Residents are totally fed up with the copious litter that is thrown down on a daily basis by the school pupils. Roads are infested with vermin, and stink of rubbish. The school has never implemented a plan to control this problem, despite numerous promises that they would. This was contingent upon the children using the gate entrance at the bottom of Gladesmore Rd.
- Rowdy, unacceptable behaviour. Residents have to put up with verbal abuse and intimidation on a daily basis. This will surely increase with the proposed plans as there will be endless streams of people wandering up and down the road.
- Parking problems. Parking is already a scarce commodity as it is. With the new block of flats estimated to bring another 30 vehicles to the area, we are curious to know where we will put our vehicles. Your proposition is bound to bring many other vehicles to the area, and this can only lead to confrontation and unhappiness on a daily basis for the residents. We would like to emphasise that this is a residential area, not a commercial one.

- Criminal behaviour. As you are aware, music and other such functions draw a crowd, and they won't all be law abiding citizens. We are sure you are also aware that we have a large number of roving criminals in the area already, gangs on bikes, gangs with dogs, etc. Their activities will surely intensify as the number of pedestrians suitable for mugging increase, and as the number of cars to have their windows smashed will increase. There are STILL no cameras (CCTV) installed on the streets and park, despite numerous requests for this every year.
- Drugs and alcohol. Events such as these planned will certainly attract problems that go with drug and alcohol-related behaviour. Again, no control can be guaranteed.

These are merely some of the points raised by the residents, and we urge you to consider very seriously the implication of your proposal. We are a residential community, and will stand together in our opposition to these plans.

Dr N. Loewke



On behalf of the Gladesmore Rd Residents Association

We, the undersigned, are completely opposed to application for the premises license and hope you will consider our objections.

Ephraim Nichtburg 98 Elm Park Ave N15 

Mark Koppel 76 ELM PARK AVE N.15

Alan Saul 37 Fairview Rd N15 6UH

David Koppel 80 ELM PARK AVE N15

DAVID ACOCA. 30. ELM PARK AVENUE LONDON N15 6AL

MICHAEL MEISER, 11 ELM PARK AVE. N15 6AL

MR GLUCK 19 WELLINGTON AVE 

Mr S Groskopf 75 Elm Park Ave N15 

KUNDU SINGH 94 ELM PARK AVE N15 6UY

Jean WILLIAMS 86 ELM Park N15 6UY

Day Cohen
84 ELM PARK AVE
N15 6UH

72 Elm Park in  Botocic

MR S. KINN 139 GLADESMORE RD
LONDON N15 6TJ 

Jacob Nichtburg 141 GLADESMORE RD N15 6TJ 

MR. MEHMET HATTATOGLU

159, GLADESMORE ROAD

LONDON N 15 6TJ

Mr. Mrs. Lewis

163 Gladesmore Rd

N. 15 6TJ.

MRS N CLARKE

167 Gladesmore Rd

N 15 6TJ.

MISS S. CLARK

169 GLADESMORE RD

N 15 6TJ

MRS E ROTTENBERG

160 GLADESMORE ROAD

LONDON N15 6TH

Miss Bessie Gibby
154 Gladesmore Rd.
London N15 6TH

MR. B UKUSA
150 GLADESMORE RD
LONDON
N15 6TH



MS J WILLIAMS

138 GLADESMORE RD
SOUTH TOTTENHAM
LONDON N15
6TH

R DANAN
136 GLADESMORE ROAD
LONDON N15 6TH

M. SHEINFELD

68 ELM PARK AVE.
LONDON N15 6Y



Mrs C. Roberts
91 ELM PARK AVE
N15 6LZ

MR H MATIAS
74 ELM PARK AVENUE
LONDON N15 6UY

MRS. P. SCHLESINGER
121 Gladesmore Rd
LONDON N15 6TL

MR. H FORBES
66 Elm Park Ave
London N15 6UY

MR Y WIENBERG
71 ELM PARK AVE
N15 6UY

John o Connor
61 ELM PARK AVE.
N15 6UY

Kathryn Seaman
121 Gladesmore Rd
N15 6UR

MR CARTER
100 ELM PARK AVE
N15 6UY

C. KOZIELEK
137 WARGRAVE AVENUE
LONDON N15 6TX

C. Kozielek

A. LIDER
130 WARGRAVE AV.
LONDON N15 6TX

E WALLS

126 WARGRAVE AVE
LONDON N15 6UA

S. COHEN

120 WARGRAVE AVE
N15 6UA

F Sprung

106 Wargrave Av
N15 6UA

f Sprung

R. Lotnig

135 WARGRAVE AVE
LONDON N15

R. Lotnig

(More to follow)

S. HANSTATER

131 WARGRAVE AVE
LONDON N15 6TX

S. DAVID

125 WARGRAVE A
N15 - 6TX

H. YESHOVA

96, WARGRAVE
AVE

N15 6UA

S. ORZEECH

123 WARGRAVE
AVE
N15 6TX

M. GROSS

115 WARGRAVE AVE
N15 6TX
M. Gross

MRS D LURIA
92 WARGRAVE AV

N15 6UE

P. Luria

MRS S. COHEN

113 WARGRAVE AVE
N15

S. Cohen

76



Mrs. Bunny Epstein
GLADESMORE ROAD RESIDENTS ASSOCIATION
 156 Gladesmore Road
 London N15 6TH
 Tel/Fax: 0208 802 0761

My Ref: Gladesmore Road Residents Association.doc.

9 October 2006

The London Borough of Haringey
 Licensing Team
 Civic Centre
 High Road
 London N22 8LE

Re: Gladesmore Community School Application for Premises License to Permit:

All listed activities are from Monday-Sunday 09.00-23.00 and they include:

- Plays
- Films
- Indoor Sporting events
- Live Music
- Recorded Music
- Dance Performances
- Making Music
- Dance

Noise Nuisance, Litter and Disorderly Behaviour

Having events at the school mean a traffic of young people down our street from morning until nearly midnight. At the moment, when the school lets out we have screaming and loutish behaviour from many students during the breaks and recesses. This is a quiet residential street with many young Orthodox Jewish Families with babies and young children, and other families with children as well as single and elderly residents.

Live music and making music are particularly obnoxious, as the sound is very loud and travels over the whole area. This will interfere with normal life of the community. Also the hours listed are quite outrageous for normal community life, going from 9.00 A.M. until 11.00 P.M. six nights of the week.

We have regularly to deal with disorderly conduct of young people, most of whom do not come from the local area and therefore do not have any allegiance or concern for the local residents and community.

Litter is a great nuisance already, and no extra concern is given to the residents of this street and area who not only have normal use of the street, litter from users of the park at the next to the school, and now the extra stress of young people and their litter –from early morning to late at night if this application is approved.

Crime and Disorder

There is also a known problem of drug dealers in the area who we worry will find an increased opportunity to deal their deadly wares under the cover of nightfall to young people

Most of the activities listed offer the potential for aggravation of already disturbing community relationships with the local Gladesmore Community School and certainly will contribute to an increase in the fearfulness of the local Jewish Community who already feel threatened by rising anti-Semitic behaviour.

We do not have the infrastructure here to have such activities take place in a safe and non threatening manner – from a person-centred point of view and from the point of view of litter, filth and the environment. We are already invaded by rats because of food which is regularly thrown onto our street.

Public Nuisance

Parking is already difficult here owing to school staff and teachers in the daytime, and we will now experience the same problems at night. This will mean people will have to park further away and walk a long way to their homes with children, shopping, heavy packages, etc. This may lead to further crime owing to confrontations with roving young people in the local area.

We hope you will consider the above representations regarding the licensing objectives and not permit this application for premises license to proceed.

Yours faithfully,



Mrs. Bunny Epstein
Counsellor/Psychotherapist

Cc:
Sara Leviton
Haringey Council
Town Hall
Tottenham
London N15 4RY

Cllr Dhiren Basu
Haringey Council
Town Hall
Tottenham
London N15 4RY

Cllr Lorna Reith
Haringey Council
Town Hall
Tottenham
London N15 4RY

Headmaster
Gladesmore Community School
Crowland Road
London N15

Agenda Item 4

<p><u>LICENSING SUB-COMMITTEE HEARINGS</u> <u>PROCEDURE SUMMARY</u></p>	<p>Tick box to record action / decisi on</p>
<p><u>INTRODUCTION</u></p>	
<p>1. The Chair introduces himself and invites other Members, Council officers, Police, Applicant and Objectors to do the same.</p>	
<p>2. The Chair invites Members to disclose any prior contacts (before the hearing) with the parties or representations received by them</p>	
<p>3. The Chair explains the procedure to be followed by reference to this summary which will be distributed.</p>	
<p><u>NON-ATTENDANCE BY PARTY OR PARTIES</u></p>	
<p>4. If one or both of the parties fails to attend, the Chair decides whether to:</p>	
<p>(i) grant an adjournment to another date, or</p>	
<p>(ii) proceed in the absence of the non-attending party.</p>	
<p>Normally, an absent party will be given one further chance to attend.</p>	
<p><u>TOPIC HEADINGS</u></p>	
<p>5. The Chair suggests the "topic headings" for the hearing.</p> <p>In the case of the majority of applications for variation of hours, or other terms and conditions, the main topic is:</p> <p>Whether the extensions of hours etc. applied for would conflict with the four licensing objectives i.e.</p>	
<p>(i) the prevention of crime and disorder,</p>	
<p>(ii) public safety,</p>	

(iii) the prevention of public nuisance, and	
(iv) the protection of children from harm.	
6. The Chair invites comments from the parties on the suggested topic headings and decides whether to confirm or vary them.	
<u>WITNESSES</u>	
7. The Chair asks whether there are any requests by a party to call a witness and decides any such request.	
8. <u>Only</u> if a witness is to be called, the Chair then asks if there is a request by an opposing party to "cross-examine" the witness. The Chair then decides any such request.	
<u>DOCUMENTARY EVIDENCE</u>	
9. The Chair asks whether there are any requests by any party to introduce late documentary evidence.	
10. If so, the Chair will ask the other party if they object to the admission of the late documents.	
11. If the other party <u>do object</u> to late admission, the following criteria shall be taken into account when the Chair decides whether or not to admit the late documents:	
(i) What is the reason for the documents being late?	
(ii) Will the other party be unfairly taken by surprise by the late documents?	
(iii) Will the party seeking to admit late documents be put at a major disadvantage if admission of the documents is refused?	
(iv) Is the late evidence really important?	
(v) Would it be better and fairer to adjourn to a later date?	
<u>THE LICENSING OFFICER'S INTRODUCTION</u>	
12. The Licensing Officer introduces the report explaining, for example, the existing hours, the hours applied for and	

<p>the comments of the other Council Services or outside official bodies. This should be as “neutral” as possible between the parties.</p>	
<p>13. The Licensing Officer can be questioned by Members and then by the parties.</p>	
<p><u>THE HEARING</u></p>	
<p>14. This takes the form of a discussion led by the Chair. The Chair can vary the order as appropriate but it should include:</p>	
<p>(i) an introduction by the Objectors' main representative</p>	
<p>(ii) an introduction by the Applicant or representative</p>	
<p>(iii) questions put by Members to the Objectors</p>	
<p>(iv) questions put by Members to the Applicant</p>	
<p>(v) questions put by the Objectors to the Applicant</p>	
<p>(vi) questions put by the Applicant to the Objectors</p>	
<p><u>CLOSING ADRESSES</u></p>	
<p>15. The Chair asks each party how much time is needed for their closing address, if they need to make one.</p>	
<p>16. Generally, the Objectors make their closing address before the Applicant who has the right to the final closing address.</p>	
<p><u>THE DECISION</u></p>	
<p>17. Members retire with the Committee Clerk and legal representative</p>	

<p>to consider their decision including the imposition of conditions.</p> <p>The decision is put in writing and Members return to the meeting.</p>	
<p>18. The Chair should read out the following statement before asking the Committee Clerk to read out in public a summary of the Committee's Decision:</p> <p><i>“The Committee Clerk will read out a summary of the Committee’s Decision. The Parties will receive a written Decision Notice in which the Decision will be formally set out. Please note that the written Decision will be substantially the same although the wording might vary slightly from the summary read out.”</i></p>	

Licensing Act 2003 Sub-Committee 14th NOVEMBER 2006

Report title: Application FOR A PREMISES LICENCE AT WETHERSPOONS, UNIT 5 SPOUTERS CORNER, HIGH ROAD LONDON N22	
Report of: The Lead Officer - Licensing	
Ward(s) affected	NOEL PARK
1. Purpose To consider an application for a variation of a Premise Licence by J D WETHERSPOON PLC to allow for regulated entertainment.	
2. Recommendations 2.1 <ul style="list-style-type: none"> (a) Grant the application as asked (b) Modify the conditions of the licence, by altering or omitting or adding to them (c) Reject the whole or part of the application <p>The Committee is asked to note that it may not modify the conditions or reject the whole or part of the application unless it is necessary to promote the licensing objectives.</p>	
Report authorised by: Robin Payne  Assistant Director Enforcement Services	
Contact Officer: Ms Daliah Barrett	
Telephone: 020 8489 5103	
3. Executive summary For consideration by Sub Committee under Licensing Act 2003 for a Premises Licence.	
4. Access to information: Local Government (Access to Information) Act 1985 Background Papers The following Background Papers are used in the preparation of this Report: File: WETHERSPOON The Background Papers are located at Enforcement Service, Civic Centre, High Road Wood Green N22	

5. REPORT

Background

- 5.1** Application by **J D WETHERSPOON PLC** for a variation of a Premises License in respect of **WETHERSPOONS, UNIT 5 SPOUTERS CORNER, HIGH ROAD LONDON N22** for regulated entertainment under the Licensing Act 2003.

The application seeks permission to allow regulated entertainment within its existing trading hours. The premises is situated at the end of the Hollywood Green Complex (Spouters Corner) and has an outside drinking area. There are a number of late night dancing venues in the immediate vicinity.

5.2 Details of application - APP 1

Opening Hours for Public

Sunday to Thursday 0700 to 0200

Friday to Saturday 0700 to 0300

Christmas Eve and Boxing Day 0700 to 0300

Regulated Entertainment

The following activities are applied for with same hours as stated above.

Films - advertisements, promotional videos, music videos and anything of the like kind.

Live Music - live music may be provided on an occasional basis

Recorded Music

Performances of dance - customers dancing

Anything of a similar nature - occasional performances by entertainers.

Provision of facilities for dance - an area will be designated for dancing when required

Provision of facilities for entertainment of a similar description.

The Current Premises Licence – APP 2

This allows for the sale of alcohol between the hours of:

Supply of Alcohol

Sunday to Thursday 0900 to 0100

Friday and Saturday 0900 to 0200

Provision of Late Night Refreshment

Sunday to Thursday 2300 to 0100

Friday and Saturday 2300 to 0200

Recorded Music

No restrictions in regards to hours

No restrictions in regards to hours for Private Entertainment

New Years Eve licensable activities from the start of permitted hours on 31

December until the start of permitted hours on 1 January

Licensable activities permitted until 0200 Christmas Eve & Boxing Day

From 0600 until the beginning of standard hours OR until 0300; on no more than 12 occasions per calendar year, extensions for the supply of alcohol can only take place if at least 7 days notice is provided to the Police and Licensing Authority and only if the Police give consent

An additional hour on the following days: Burns Night (25th January), Australia Day (26th January), St David's Day (1st March), St Patrick's Day (17th March), St George's Day (23rd April), St Andrew's Day (30th November), Thursday Preceding Good Friday, Sundays preceding Bank Holiday Mondays & on the morning of the day the clocks go forward

The licence also makes reference to regulated entertainment- Please note that the applicants claimed their ability to carry over this function as an embedded right. Various forms of regulated entertainment is available under this right but only for private entertainment, i.e. the public are not able to gain access to any of the entertainment being provided. There are no restrictions to the times in which private entertainment can be carried out

The Operating Schedule.**5.3 Crime and Disorder**

The applicant advises that the existing condition can be relied upon. Please see App 2.

5.4 Public Safety**5.5 Public Nuisance****5.6 Child Protection**

6. RELEVANT REPRESENTATIONS (CONSULTATION)

Responsible Authorities:

6.1 Comments of Metropolitan Police

The Police have commented to advise, that an agreement has been reached for the use of 2 SIA registered door supervisor to be on duty Friday and Saturday night from 21.00 to close of business.

6.2 Comments of Enforcement Services:

Noise Team

Have not made a representation.

Food Team

Have no objections to this application

Health and Safety

Have no objections to this application

Trading Standards

Have no objections to this application

6.3 Fire Officer

The Fire Officer has made no representation in relation to this application.

6.4 Planning Officer

Planning have made no representation on this matter.

6.5 Comments of Child Protection Agency or Nominee

Have no objections to this application.

7.0 Interested Parties

4 letters of representation has been received against this application. **App 3**

8.0 Financial Comments

The fee which would be applicable for this application is **£635.00**

Appendix 1

APPLICATION FORM



This map is reproduced from Ordnance Survey material with the permission of the Ordnance Survey on behalf of the Controller of Her Majesty's Stationery Office © Crown copyright. Unauthorised reproduction infringes Crown copyright and may lead to prosecution or civil proceedings. LB Haringey 100017423 2005

Town and Country Planning Act 1990 (As amended)
Plan relating to the Enforcement Notice dated
Unit 5, Hollywood Green, 180 High Road, Wood Green N22

HARINGEY COUNCIL

**Directorate of
 Environmental
 Services**

Robin Payne
 Assistant Director
 Enforcement Service
 639 High Road
 London N17 8BD
 Tel 020 8489 0000
 Fax 020 8489 5525

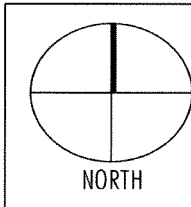

Drawn by	Haringey Council
Scale	1:1250
Date	27/10/2006
Drawing	N/A



Application to vary a premises licence under the Licensing Act 2003

PLEASE READ THE FOLLOWING INSTRUCTIONS FIRST

Before completing this form please read the guidance notes at the end of the form.
If you are completing this form by hand please write legibly in block capitals. In all cases ensure that your answers are inside the boxes and written in black ink. Use additional sheets if necessary.

You may wish to keep a copy of the completed form for your records.

I/We J D WETHERSPOON PLC

(Insert name(s) of applicant)

being the premises licence holder, apply to vary a premises licence under section 34 of the Licensing Act 2003 for the premises described in Part 1 below

Premises licence number

LN00002161

Part 1 – Premises Details

Postal address of premises or, if none, ordnance survey map reference or description

WETHERSPOONS
UNIT 5 SPOUTER'S CORNER
HIGH ROAD

Post town

WOOD GREEN

Post code

N22 6EK

Telephone number at premises (if any)

020 8881 3891

Non-domestic rateable value of premises

£152000

Part 2 – Applicant details

Daytime contact
telephone number

01923 477 777

E-mail address (optional)

Current postal address if
different from premises
address

J D WETHERSPOON PLC
WETHERSPOON HOUSE
REEDS CRESCENT

Post Town

WATFORD

Postcode

WD24 4QL

Part 3 - Variation

Please tick yes

Do you want the proposed variation to have effect as soon as possible?

If not do you want the variation to take effect from

Day	Month	Year

Please describe briefly the nature of the proposed variation (Please see guidance note 1)

TO PERMIT REGULATED ENTERTAINMENT FROM 0700 TO CLOSE OF PREMISES

If your proposed variation would mean that 5,000 or more people are expected to attend the premises at any one time, please state the number expected to attend

0

Part 4 Operating Schedule

Please complete those parts of the Operating Schedule below which would be subject to change if this application to vary is successful.

Provision of regulated entertainment

Please tick yes

- a) plays (if ticking yes, fill in box A)
- b) films (if ticking yes, fill in box B)
- c) indoor sporting events (if ticking yes, fill in box C)
- d) boxing or wrestling entertainment (if ticking yes, fill in box D)
- e) live music (if ticking yes, fill in box E)
- f) recorded music (if ticking yes, fill in box F)
- g) performances of dance (if ticking yes, fill in box G)
- h) anything of a similar description to that falling within (e), (f) or (g) (if ticking yes, fill in box H)

Provision of entertainment facilities:

- i) making music (if ticking yes, fill in box I)
- j) dancing (if ticking yes, fill in box J)
- k) entertainment of a similar description to that falling within (i) or (j) (if ticking yes, fill in box K)

Provision of late night refreshment (if ticking yes, fill in box L)

Sale by retail of alcohol (if ticking yes, fill in box M)

In all cases complete boxes N, O and P

A

Plays Standard days and timings (please read guidance note 6)			<u>Will the performance of a play take place indoors or outdoors or both – please tick</u> (please read guidance note 2)	Indoors	<input type="checkbox"/>
Day	Start	Finish		Outdoors	<input type="checkbox"/>
				Both	<input type="checkbox"/>
Mon				<u>Please give further details here</u> (please read guidance note 3)	
Tue					
Wed			<u>State any seasonal variations for performing plays</u> (please read guidance note 4)		
Thur					
Fri			<u>Non standard timings. Where you intend to use the premises for the performance of plays at different times to those listed in the column on the left, please list</u> (please read guidance note 5)		
Sat					
Sun					

B

Films Standard days and timings (please read guidance note 6)			<u>Will the exhibition of films take place indoors or outdoors or both – please tick</u> (please read guidance note 2)	Indoors	<input checked="" type="checkbox"/>
Day	Start	Finish		Outdoors	<input type="checkbox"/>
				Both	<input type="checkbox"/>
Mon	0700	0200	<u>Please give further details here</u> (please read guidance note 3) ADVERTISEMENTS, PROMOTIONAL VIDEOS, MUSIC VIDEOS, AND ANYTHING OF THE LIKE KIND		
Tue	0700	0200			
Wed	0700	0200	<u>State any seasonal variations for the exhibition of films</u> (please read guidance note 4) THE APPLICANT REQUIRES THE ABILITY TO OPERATE REGULATED ENTERTAINMENT AT ALL TIMES UNTIL THE TIME SPECIFIED IN THE PREMISES LICENCE FOR CLOSING		
Thur	0700	0200			
Fri	0700	0300	<u>Non standard timings. Where you intend to use the premises for the exhibition of films at different times to those listed in the column on the left, please list</u> (please read guidance note 5) THE APPLICANT REQUIRES THE ABILITY TO OPERATE REGULATED ENTERTAINMENT AT ALL TIMES UNTIL THE TIME SPECIFIED IN THE PREMISES LICENCE FOR CLOSING		
Sat	0700	0300			
Sun	0700	0200			

C

Indoor sporting events Standard days and timings (please read guidance note 6)			Please give further details (please read guidance note 3)
Day	Start	Finish	
Mon			State any seasonal variations for indoor sporting events (please read guidance note 4)
Tue			
Wed			
Thur			Non standard timings. Where you intend to use the premises for indoor sporting events at different times to those listed in the column on the left, please list (please read guidance note 5)
Fri			
Sat			
Sun			

D

Boxing or wrestling entertainments Standard days and timings (please read guidance note 6)			Will the boxing or wrestling entertainment take place indoors or outdoors or both – please tick (please read guidance note 2)	Indoors	<input type="checkbox"/>
				Outdoors	<input type="checkbox"/>
				Both	<input type="checkbox"/>
Day	Start	Finish	Please give further details here (please read guidance note 3)		
Mon					
Tue			State any seasonal variations for boxing or wrestling entertainment (please read guidance note 4)		
Wed					
Thur			Non standard timings. Where you intend to use the premises for boxing or wrestling entertainment at different times to those listed in the column on the left, please list (please read guidance note 5)		
Fri					
Sat					
Sun					

E

Live music Standard days and timings (please read guidance note 6)			<u>Will the performance of live music take place indoors or outdoors or both – please tick</u> (please read guidance note 2)	Indoors	<input checked="" type="checkbox"/>
Day				Start	Finish
Mon				0700	0200
Tue				0700	0200
			<u>Please give further details here</u> (please read guidance note 3)		
LIVE MUSIC MAY BE PROVIDED ON AN OCCASIONAL BASIS					
Wed			0700	0200	<u>State any seasonal variations for the performance of live music</u> (please read guidance note 4)
Thur			0700	0200	
Fri			0700	0300	
Sat			0700	0300	
Sun			0700	0200	<u>Non standard timings. Where you intend to use the premises for the performance of live music at different times to those listed in the column on the left, please list</u> (please read guidance note 5)
THE APPLICANT REQUIRES THE ABILITY TO OPERATE REGULATED ENTERTAINMENT AT ALL TIMES UNTIL THE TIME SPECIFIED IN THE PREMISES LICENCE FOR CLOSING					

F

Recorded music Standard days and timings (please read guidance note 6)			<u>Will the playing of recorded music take place indoors or outdoors or both – please tick</u> (please read guidance note 2)	Indoors	<input checked="" type="checkbox"/>
Day				Outdoors	<input type="checkbox"/>
Start	Finish			Both	<input type="checkbox"/>
Mon	0700	0200	<u>Please give further details here</u> (please read guidance note 3)		
Tue	0700	0200			
Wed	0700	0200	<u>State any seasonal variations for the playing of recorded music</u> (please read guidance note 4)		
Thur	0700	0200		THE APPLICANT REQUIRES THE ABILITY TO OPERATE REGULATED ENTERTAINMENT AT ALL TIMES UNTIL THE TIME SPECIFIED IN THE PREMISES LICENCE FOR CLOSING	
Fri	0700	0300	<u>Non standard timings. Where you intend to use the premises for the playing of recorded music at different times to those listed in the column on the left, please list</u> (please read guidance note 5)		
Sat	0700	0300			
Sun	0700	0200		THE APPLICANT REQUIRES THE ABILITY TO OPERATE REGULATED ENTERTAINMENT AT ALL TIMES UNTIL THE TIME SPECIFIED IN THE PREMISES LICENCE FOR CLOSING	

G

Performances of dance Standard days and timings (please read guidance note 6)			<u>Will the performance of dance take place indoors or outdoors or both – please tick</u> (please read guidance note 2)	Indoors	<input checked="" type="checkbox"/>
				Outdoors	<input type="checkbox"/>
				Both	<input type="checkbox"/>
Day	Start	Finish			
Mon	0700	0200	<u>Please give further details here</u> (please read guidance note 3) CUSTOMER DANCING		
Tue	0700	0200			
Wed	0700	0200	<u>State any seasonal variations for the performance of dance</u> (please read guidance note 4)		
Thur	0700	0200	THE APPLICANT REQUIRES THE ABILITY TO OPERATE REGULATED ENTERTAINMENT AT ALL TIMES UNTIL THE TIME SPECIFIED IN THE PREMISES LICENCE FOR CLOSING		
Fri	0700	0300	<u>Non standard timings. Where you intend to use the premises for the performance of dance at different times to those listed in the column on the left, please list</u> (please read guidance note 5) THE APPLICANT REQUIRES THE ABILITY TO OPERATE REGULATED ENTERTAINMENT AT ALL TIMES UNTIL THE TIME SPECIFIED IN THE PREMISES LICENCE FOR CLOSING		
Sat	0700	0300			
Sun	0700	0200			

H

Anything of a similar description to that falling within (e), (f) or (g) Standard days and timings (please read guidance note 6)			<u>Please give a description of the type of entertainment you will be providing</u> OCCASIONAL PERFORMANCES BY ENTERTAINERS		
Day	Start	Finish	<u>Will this entertainment take place indoors or outdoors or both – please tick</u> (please read guidance note 2)	Indoors	<input checked="" type="checkbox"/>
Mon	0700	0200		Outdoors	<input type="checkbox"/>
				Both	<input type="checkbox"/>
Tue	0700	0200	<u>Please give further details here</u> (please read guidance note 3)		
Wed	0700	0200			
Thur	0700	0200	<u>State any seasonal variations for entertainment of a similar description to that falling within (e), (f) or (g)</u> (please read guidance note 4)		
Fri	0700	0300	THE APPLICANT REQUIRES THE ABILITY TO OPERATE REGULATED ENTERTAINMENT AT ALL TIMES UNTIL THE TIME SPECIFIED IN THE PREMISES LICENCE FOR CLOSING		
Sat	0700	0300	<u>Non standard timings. Where you intend to use the premises for the entertainment of a similar description to that falling within (e), (f) or (g) at different times to those listed in the column on the left, please list</u> (please read guidance note 5)		
Sun	0700	0200	THE APPLICANT REQUIRES THE ABILITY TO OPERATE REGULATED ENTERTAINMENT AT ALL TIMES UNTIL THE TIME SPECIFIED IN THE PREMISES LICENCE FOR CLOSING		

I

Provision of facilities for making music Standard days and timings (please read guidance note 6)			<u>Please give a description of the facilities for making music you will be providing</u>	
			<u>Will the facilities for making music be indoors or outdoors or both – please tick</u> (please read guidance note 2)	
Indoors	<input checked="" type="checkbox"/>			
Outdoors	<input type="checkbox"/>			
Both	<input type="checkbox"/>			
Day	Start	Finish	<u>Please give further details here</u> (please read guidance note 3)	
Mon	0700	0200		
Tue	0700	0200	<u>State any seasonal variations for the provision of facilities for making music</u> (please read guidance note 4)	
Wed	0700	0200		
Thur	0700	0200	THE APPLICANT REQUIRES THE ABILITY TO OPERATE REGULATED ENTERTAINMENT AT ALL TIMES UNTIL THE TIME SPECIFIED IN THE PREMISES LICENCE FOR CLOSING	
Fri	0700	0300	<u>Non standard timings. Where you intend to use the premises for provision of facilities for making music at different times to those listed in the column on the left, please list</u> (please read guidance note 5)	
Sat	0700	0300		
Sun	0700	0200	THE APPLICANT REQUIRES THE ABILITY TO OPERATE REGULATED ENTERTAINMENT AT ALL TIMES UNTIL THE TIME SPECIFIED IN THE PREMISES LICENCE FOR CLOSING	

J

Provision of facilities for dancing Standard days and timings (please read guidance note 6)			Will the facilities for dancing be indoors or outdoors or both – please tick (see guidance note 2)	Indoors <input checked="" type="checkbox"/>
				Outdoors <input type="checkbox"/>
				Both <input type="checkbox"/>
			Please give a description of the facilities for dancing you will be providing	
Day	Start	Finish	AN AREA WILL BE DESIGNATED FOR DANCING WHEN REQUIRED	
Mon	0700	0200	Please give further details here (please read guidance note 3)	
Tue	0700	0200		
Wed	0700	0200	State any seasonal variations for providing dancing facilities (please read guidance note 4)	
Thur	0700	0200	THE APPLICANT REQUIRES THE ABILITY TO OPERATE REGULATED ENTERTAINMENT AT ALL TIMES UNTIL THE TIME SPECIFIED IN THE PREMISES LICENCE FOR CLOSING	
Fri	0700	0300	Non standard timings. Where you intend to use the premises for the provision of facilities for dancing at different times to those listed in the column on the left, please list (please read guidance note 5)	
Sat	0700	0300		
Sun	0700	0200	THE APPLICANT REQUIRES THE ABILITY TO OPERATE REGULATED ENTERTAINMENT AT ALL TIMES UNTIL THE TIME SPECIFIED IN THE PREMISES LICENCE FOR CLOSING	

K

Provision of facilities for entertainment of a similar description to that falling within i or j Standard days and timings (please read guidance note 6)			<u>Please give a description of the type of entertainment facility you will be providing</u>		
Day	Start	Finish	<u>Will the entertainment facility be indoors or outdoors or both – please tick</u> (please read guidance note 2)	Indoors	<input checked="" type="checkbox"/>
Mon	0700	0200		Outdoors	<input type="checkbox"/>
				Both	<input type="checkbox"/>
Tue	0700	0200	<u>Please give further details here</u> (please read guidance note 3)		
Wed	0700	0200			
Thur	0700	0200	<u>State any seasonal variations for the provision of facilities for entertainment of a similar description to that falling within i or j</u> (please read guidance note 4)		
Fri	0700	0300	THE APPLICANT REQUIRES THE ABILITY TO OPERATE REGULATED ENTERTAINMENT AT ALL TIMES UNTIL THE TIME SPECIFIED IN THE PREMISES LICENCE FOR CLOSING		
Sat	0700	0300	<u>Non standard timings. Where you intend to use the premises for the provision of facilities for entertainment of a similar description to that falling within i or j at different times to those listed in the column on the left, please list</u> (please read guidance note 5)		
Sun	0700	0200	THE APPLICANT REQUIRES THE ABILITY TO OPERATE REGULATED ENTERTAINMENT AT ALL TIMES UNTIL THE TIME SPECIFIED IN THE PREMISES LICENCE FOR CLOSING		

L

Late night refreshment Standard days and timings (please read guidance note 6)			Will the provision of late night refreshment take place indoors or outdoors or both – please tick (please read guidance note 2)	Indoors	<input type="checkbox"/>
				Outdoors	<input type="checkbox"/>
				Both	<input type="checkbox"/>
Day	Start	Finish	Please give further details here (please read guidance note 3) NO EXTENSION IS SOUGHT TO EXISTING HOURS		
Mon					
Tue			State any seasonal variations for the provision of late night refreshment (please read guidance note 4)		
Wed					
Thur			Non standard timings. Where you intend to use the premises for the provision of late night refreshment at different times, to those listed in the column on the left, please list (please read guidance note 5)		
Fri					
Sat					
Sun					

M

Supply of alcohol Standard days and timings (please read guidance note 6)			Will the supply of alcohol be for consumption (Please tick box) (please read guidance note 7)	On the premises	<input type="checkbox"/>
				Off the premises	<input type="checkbox"/>
				Both	<input type="checkbox"/>
Day	Start	Finish			
Mon			State any seasonal variations for the supply of alcohol (please read guidance note 4) NO EXTENSION IS SOUGHT TO THE EXISTING HOURS		
Tue					
Wed					
Thur			Non-standard timings. Where you intend to use the premises for the supply of alcohol at different times to those listed in the column on the left, please list (please read guidance note 5)		
Fri					
Sat					
Sun					

N

<p>Please highlight any adult entertainment or services, activities, other entertainment or matters ancillary to the use of the premises that may give rise to concern in respect of children (please read guidance note 8)</p> <p>NONE</p>
--

O

Hours premises are open to the public Standard days and timings (please read guidance note 6)			State any seasonal variations (please read guidance note 4) NO EXTENSION IS SOUGHT TO THE EXISTING HOURS.
Day	Start	Finish	
Mon			Non standard timings. Where you intend the premises to be open to the public at different times from those listed in the column on the left, please list (please read guidance note 5)
Tue			
Wed			
Thur			
Fri			
Sat			
Sun			

Please identify those conditions currently imposed on the licence which you believe could be removed as a consequence of the proposed variation you are seeking

NONE

Please tick yes

- I have enclosed the premises licence
- I have enclosed the relevant part of the premises licence

If you have not ticked one of these boxes please fill in reasons for not including the licence, or part of it, below

Reasons why I have failed to enclose the premises licence or relevant part of premises licence

P Describe any additional steps you intend to take to promote the four licensing objectives as a result of the proposed variation:

a) General – all four licensing objectives (b,c,d,e) (please read guidance note 9)

THE EXISTING CONDITIONS WILL BE RELIED UPON

b) The prevention of crime and disorder

AS BOX A ABOVE

c) Public safety

AS BOX A ABOVE

d) The prevention of public nuisance

AS BOX A ABOVE

e) The protection of children from harm

AS BOX A ABOVE

Please tick yes

- I have made or enclosed payment of the fee
- I have sent copies of this application and the plan to responsible authorities and others where applicable
- I understand that I must now advertise my application
- I have enclosed the premises licence or relevant part of it or explanation
- I understand that if I do not comply with the above requirements my application will be rejected

IT IS AN OFFENCE, LIABLE ON CONVICTION TO A FINE UP TO LEVEL 5 ON THE STANDARD SCALE, UNDER SECTION 158 OF THE LICENSING ACT 2003 TO MAKE A FALSE STATEMENT IN OR IN CONNECTION WITH THIS APPLICATION

Part 5 – Signatures (please read guidance note 10)

Signature of applicant (the current premises licence holder) or applicant’s solicitor or other duly authorised agent (please read guidance note 11). If signing on behalf of the applicant please state in what capacity.

Signature	
Date	22.09.06
Capacity	SOLICITORS ON BEHALF OF THE APPLICANT

Where the premises licence is jointly held signature of 2nd applicant (the current premises licence holder) or 2nd applicant’s solicitor or other authorised agent (please read guidance note 12). If signing on behalf of the applicant please state in what capacity.

Signature	
Date	
Capacity	

Contact name (where not previously given) and address for correspondence associated with this application (please read guidance note 13)

NIGEL CONNOR
 McLELLANS SOLICITORS
 OLD CROSS HOUSE
 OLD CROSS

Post town	HERTFORD	Post code	SG14 1RB
-----------	----------	-----------	----------

Telephone number (if any)	01992 532 000
---------------------------	---------------

If you would prefer us to correspond with you by e-mail your e-mail address (optional)

Notes for Guidance

This application cannot be used to vary the licence so as to extend the period for which the licence has effect or to vary substantially the premises to which it relates. If you wish to make that type of change to the premises licence you should make a new premises licence application under section 17 of the Licensing Act 2003.

1. Describe the premises. For example the type of premises, its general situation and layout and any other information which could be relevant to the licensing objectives. Where your application includes off-supplies of alcohol and you intend to provide a place for consumption of these off-supplies you must include a description of where the place will be and its proximity to the premises.
2. Where taking place in a building or other structure please tick as appropriate. Indoors may include a tent.
3. For example state type of activity to be authorised, if not already stated, and give relevant further details, for example (but not exclusively) whether or not music will be amplified or unamplified.
4. For example (but not exclusively), where the activity will occur on additional days during the summer months.
5. For example (but not exclusively), where you wish the activity to go on longer on a particular day e.g. Christmas Eve.
6. Please give timings in 24 hour clock (e.g. 16:00) and only give details for the days of the week when you intend the premises to be used for the activity.
7. If you wish people to be able to consume alcohol on the premises please tick on, if you wish people to be able to purchase alcohol to consume away from the premises please tick off. If you wish people to be able to do both please tick both.
8. Please give information about anything intended to occur at the premises or ancillary to the use of the premises which may give rise to concern in respect of children regardless of whether you intend children to have access to the premises, for example (but not exclusively) nudity or semi-nudity, films for restricted age groups, the presence of gaming machines.
9. Please list here steps you will take to promote all four licensing objectives together.
10. The application form must be signed.
11. An applicant's agent (for example solicitor) may sign the form on their behalf provided that they have actual authority to do so.
12. Where there is more than one applicant, both applicants or their respective agents must sign the application form.
13. This is the address which we shall use to correspond with you about this application.

Appendix 2

CURRENT LICENCE



PREMISES LICENCE

Receipt: AG754760

Premises Licence Number: LN00002161

This Premises Licence has been issued by:

**The Licensing Authority, London Borough of Haringey,
Civic Centre, High Road, Wood Green,
London, N22 8LE**

Signature:.....

Date: 24TH November 2005

Part 1 – PREMISES DETAILS

Postal Address of Premises or, if none, Ordnance Survey map reference or description:

**WETHERSPOONS
UNIT 5 SPOUTER'S CORNER
HIGH ROAD
WOOD GREEN
LONDON
N22 6EJ**

Telephone: 020 8881 3891

Where the Licence is time limited, the dates:

N/A

Licensable activities authorised by the Licence:

Supply of Alcohol

Provision of Late Night Refreshment

The Provision of Regulated Entertainment: Recorded Music

Licensable activities authorised by the Licence for Private Entertainment:

The Provision of Regulated Entertainment: Live Music, Recorded Music, Performances of Dance and anything of a similar description and Provision of Entertainment Facilities for Making Music, Dancing and Entertainment of a Similar Description

The Provision of the above Regulated Entertainment and Entertainment Facilities shall be restricted to those events which are private and when members of the public are refused admission

The times the Licence authorises the carrying out of licensable activities:

Supply of Alcohol

Sunday to Thursday 0900 to 0100

Friday and Saturday 0900 to 0200



LICENSING ACT 2003

Sec 24



HARINGEY COUNCIL

Provision of Late Night Refreshment**Sunday to Thursday 2300 to 0100****Friday and Saturday 2300 to 0200****Recorded Music****No restrictions in regards to hours****No restrictions in regards to hours for Private Entertainment****New Years Eve licensable activities from the start of permitted hours on 31 December until the start of permitted hours on 1 January****Licensable activities permitted until 0200 Christmas Eve & Boxing Day****From 0600 until the beginning of standard hours OR until 0300; on no more than 12 occasions per calendar year, extensions for the supply of alcohol can only take place if at least 7 days notice is provided to the Police and Licensing Authority and only if the Police give consent****An additional hour on the following days: Burns Night (25th January), Australia Day (26th January), St David's Day (1st March), St Patrick's Day (17th March), St George's Day (23rd April), St Andrew's Day (30th November), Thursday Preceding Good Friday, Sundays preceding Bank Holiday Mondays & on the morning of the day the clocks go forward****The opening hours of the premises:****Sunday to Thursday 0700 to 0200****Friday to Saturday 0700 to 0300****Christmas Eve and Boxing Day 0700 to 0300****Additional hours as listed in non-standard timings****New Years Eve opening hours from the start of permitted hours on 31 December until the start of permitted hours on 1 January****Where the Licence authorises supplies of alcohol whether these are on and/or off supplies:**Supply of alcohol for consumption both **ON** and **OFF** the premises.**Part 2****Name, (registered) address, telephone number and e-mail (where relevant) of holder of Premises Licence:**

JD Wetherspoon Plc
 Wetherspoon House
 Reeds Crescent
 Watford
 WD24 4QL



LICENSING ACT 2003

Sec 24



HARINGEY COUNCIL

Registered number of holder, for example company number, charity number (where applicable):

01709784

Name, address and telephone number of designated premises supervisor where the Premises Licence authorises the supply of alcohol:

Jacqueline Forshaw
C/o: WETHERSPOONS
UNIT 5 SPOUTER'S CORNER
HIGH ROAD
WOOD GREEN
LONDON
N22 6EJ

Personal Licence number and issuing authority of personal licence held by designated premises supervisor where the Premises Licence authorises for the supply of alcohol:

LN/00002274

Issued by London Borough of Haringey

Expires: 23rd November 2015





Annex 1 -Mandatory Conditions

Section 19 - Supply of alcohol

(2) No supply of alcohol may be made under the premises licence-

- (a) at a time when there is no designated premises supervisor in respect of the premises licence, or
 - (b) at a time when the designated premises supervisor does not hold a personal licence or his personal licence is suspended.
- (3) The second condition is that every supply of alcohol under the premises licence must be made or authorised by a person who holds a personal licence.

Section 21 - Door supervision

At specified times one or more individuals must be at the premises to carry out a security activity and each of these individuals must be licensed by the Security Industry Authority.





Annex 2 – Conditions consistent with the Operating Schedule

Existing company procedures will be applied to the premises in relation to the additional hours. The measures set out in the Overview of Operations and JD Wetherspoon-Approach to Responsible Drinks Retailing will continue to apply to the additional hours sought by this variation.

THE PREVENTION OF CRIME AND DISORDER

The Company will be committed to strict compliance with the law in the course of the operation of its premises and to maintaining good standards of behaviour by its customers.

JD Wetherspoon will assess the risk of the necessity for door supervisors at the premises at regular intervals and will employ them as needed.

PUBLIC SAFETY

JD Wetherspoon will undertake ongoing risk assessments in order to comply with Health and Safety legislation.

THE PREVENTION OF PUBLIC NUISANCE

THE PROTECTION OF CHILDREN

It will be company policy that children will be required to vacate the bar by 21.00 hours unless they are eating in which case they will be required to vacate the Bar by 21.30 hours. Children must always be accompanied by an adult who will be required to maintain constant supervision of them.

Alcohol may only be sold to individuals over the age of 18 with valid proof of identification with one of the following:

- A valid passport
- A photo driving license issued in a European Union Country
- A proof of age standard card system
- A citizen card, supported by the Home Office

If any licensed doorman or member of staff of the premises has any doubt as to the age of any potential patron, then that person will be refused entry.





Annex 3 – Conditions attached after a hearing by the licensing authority

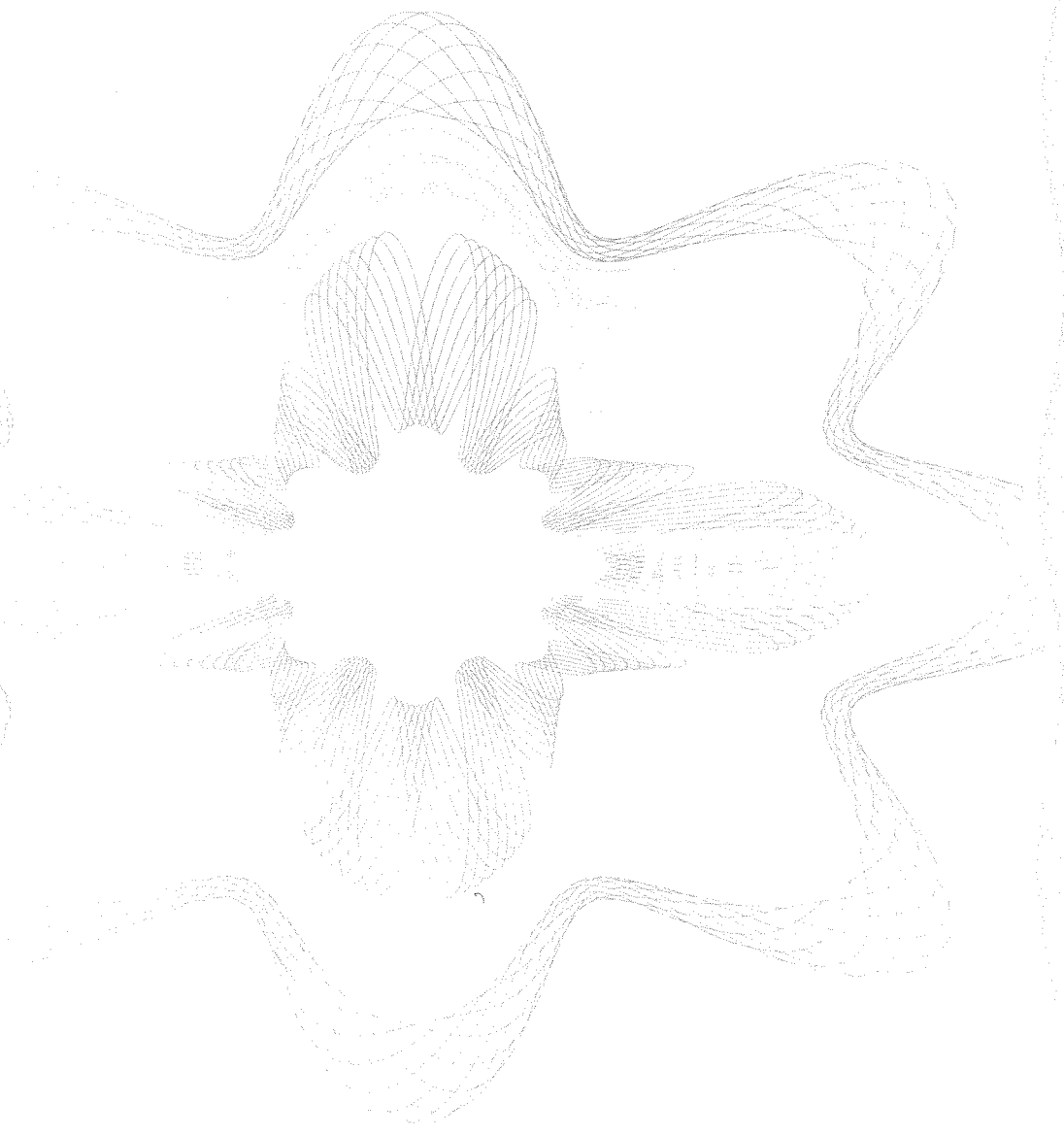



Annex 4 – Plans

LODGED WITH LICENSING AUTHORITY



Appendix 3

LETTERS OF REPRESENTATION FROM
RESIDENTS AND PEOPLE WORKING IN
THE VICINITY.

File

Shout
Unit 4
Spouters Corner
Wood Green
London
N22 6EN

Licensing Department
Haringey Council
Civic Centre
High Road
Wood Green
N22 8LE



5th October 2006

Dear Dalleh

As a business neighbour of Wetherspoons, I wish to make the following representations with regards to their application to permit live music, live entertainment, dancing and recorded music from 7am to 2am Sunday to Thursday, and 7am to 3am Saturday and Sunday.

The Prevention of Crime and Disorder

By permitting Wetherspoons to carry out these licensable activities 19 hours a day during the week and 20 hours a day at weekends, there is a probability that crime and disorder related to the area will rise.

Dispersal at the end of the evening on Friday and Saturday becomes an issue in relation to public place violent crime. It is recognised that staggered finishing times of licensable activities in venues within close proximity helps to reduce crime and disorder. By finishing some licensable activities at 3am, Wetherspoons' customers would be exiting onto the street at the same time as Shout customers, thus creating a potential flashpoint.

Public Safety

Wetherspoons does not currently operate with SIA registered door supervisors. According to their application, they have not suggested that this should be a condition, allowing them to continue trading without door supervisors. This has a major impact upon their ability to meet the public safety objective of the Licensing Act 2003.

The building is designed to be, and has been operated successfully as, a public house, with the emphasis on “value for money” drinks prices and food. The application signifies a substantial change of use, to a venue providing dancing, live music, recorded music, and live entertainment until 3am, the activities of a late night discothèque. Because the operating policy and building design are that of a public house rather than a night club, public safety becomes an issue.

It would be unthinkable for an experienced operator of late night entertainment premises to apply for the activities and times that have been requested, without proposing the employment of SIA registered door staff as a condition.

Public Nuisance

There is obvious potential for nuisance to the local residents by operating live music, live entertainment and dancing for up to 19 hours per day (20 hours at weekends) in an area which is primarily residential. Whilst Wetherspoons may not, at this moment in time, intend to utilise the full extent of their licensable activities, there would be nothing to stop them doing so should their application be approved.

For the reasons stated above, I believe that the application should be rejected because it does not fulfil the objectives of the Licensing Act 2003.

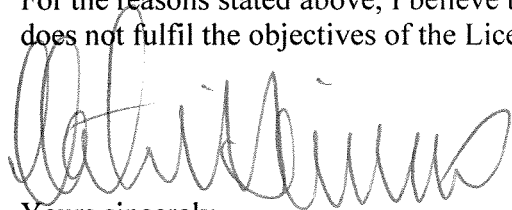

Yours sincerely,
Martin Harris
General Manager



4 Moselle Avenue
Wood Green
London N22 6ES

10 October 2006

Ms Daliah Barrett
Licensing Enforcement Services
Haringey Council
Civic Centre
High Road
London N22 8LE

Dear Ms Barrett

Re: Application by Weatherspoons at Unit 5 Spouters Corner - Permit for Live Music and Disco

As local residents we seriously oppose this application. Given the Government's concerns about the general increase in anti-social behaviour associated with drinking, we can see no justification for any license being granted for a 7am start and a 2/3am finish seven days a week.

Surely no one should have to put up with this as we live in a residential area very close to this public house and are most concerned about the increased noise etc. created by revellers returning to their cars, banging car doors, hooting their horns, shouting, singing, plus the added health hazard by throwing their unwanted food/rubbish in our road and front gardens, and worse, urinating.

We are appalled by the thought for those of us who have work the next day and for the elderly residents, so we urge you to reject this application.

I look forward to your reply

Yours sincerely



Mrs B Greensmith



|| Moselle Avenue
Wood Green
London N22

10 October 2006

Ms Daliah Barrett
Licensing Enforcement Services
Haringey Council
Civic Centre
High Road
London N22 8LE

Dear Ms Barrett

Re: Application by Weatherspoons at Unit 5 Spouters Corner - Permit for Live Music and Disco

As local residents we seriously oppose this application. Given the Government's concerns about the general increase in anti-social behaviour associated with drinking, we can see no justification for any license being granted for a 7am start and a 2/3am finish seven days a week.

Surely no one should have to put up with this as we live in a residential area very close to this public house and are most concerned about the increased noise etc. created by revellers returning to their cars, banging car doors, hooting their horns, shouting, singing, plus the added health hazard by throwing their unwanted food/rubbish in our road and front gardens, and worse, urinating.

We are appalled by the thought for those of us who have work the next day and for the elderly residents, so we urge you to reject this application.

I look forward to your reply

Yours sincerely

Mrs Katie Cornell

K Cornell

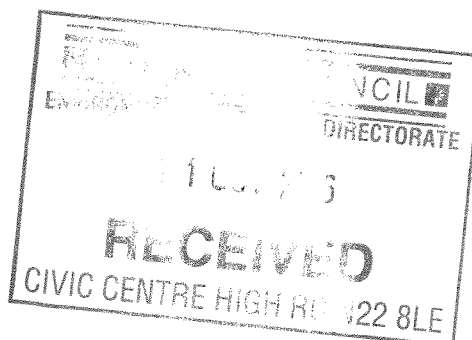

MRS. C. CHRYSAFI
35. GLADSTONE AVE
WOODGREEN
LONDON N22 6JL
020 8889 2716

14-10-06

DEAR MR OR MRS Daliah,

My Husband and I would be very upset for Wetherspoons to have a license For Discos and live music From 7am to 2am Sunday to Thursday. we have enough noise as it is, what with buses and clubs Fridays and Saters we are getting so many drunk peop that shout and argue all through the night. we seldom get any sleep. it is. it would be a nightmare for Wetherspoons to add to all this, we would like them to trade at there existing hours.

Yours

Sincerely

Mrs C Chrysaifi
C Chrysaifi

This page is intentionally left blank